

CONVENTION AND MEETING SPACE FLOOR PLANS AND CAPACITIES

CONTACT:

sales@cosmopolitanlasvegas.com

Call toll free: 1.877.763.2267

cosmopolitanlasvegas.com



THE COSMOPOLITAN™
of LAS VEGAS

SECOND LEVEL

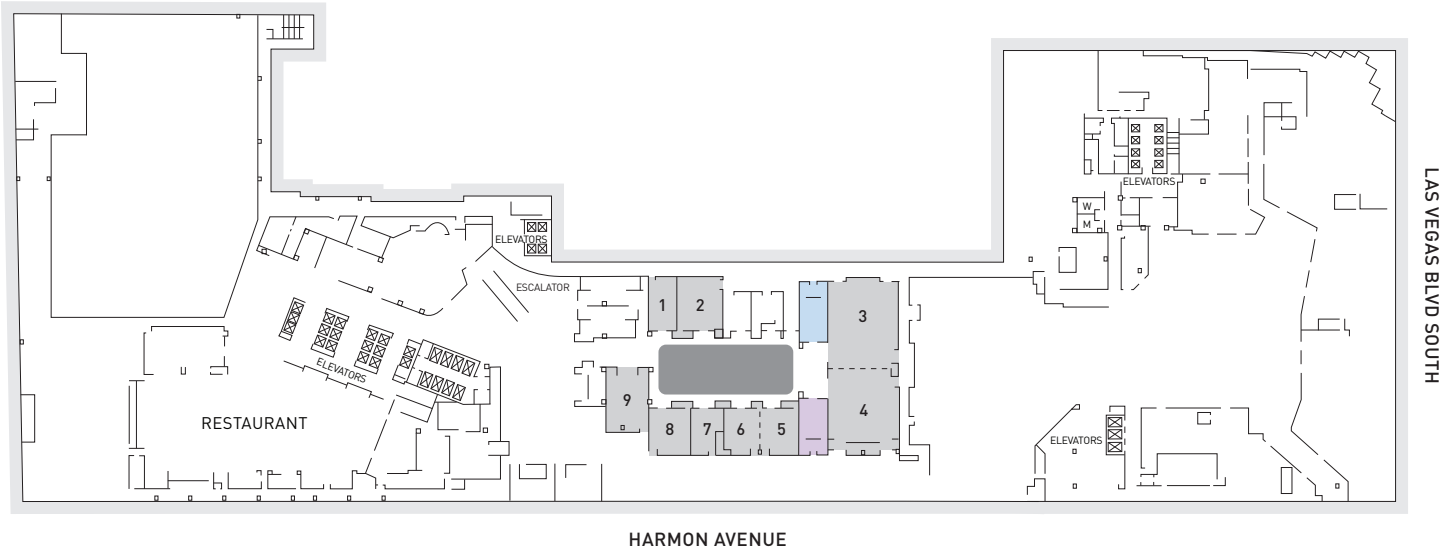

Room Name	Room Dimensions L x W x H	Square Feet*	Banquet 72" Rd.	Theater	Classroom 18"	Reception	Hollow Square	Exhibit 8' x 10'	Exhibit 10' x 10'
Condesa 1	42 x 22 x 11	924	50	92	62	132	22	—	—
Condesa 2	42 x 36 x 13	1,512	90	151	101	216	42	—	—
Condesa 3	67 x 55 x 12	3,685	230	369	246	526	—	21	17
Condesa 4	63 x 55 x 12	3,465	210	347	231	495	—	21	17
Condesa 3-4	130 x 55 x 12	7,150	440	715	477	1,021	—	43	35
Condesa 5	37 x 28 x 13	1,036	60	104	69	148	26	—	—
Condesa 6	37 x 30 x 13	1,110	60	111	74	159	26	—	—
Condesa 5-6	58 x 37 x 13	2,146	130	215	143	307	52	13	10
Condesa 7	36 x 25 x 11	900	60	90	60	129	18	—	—
Condesa 8	36 x 32 x 13	1,152	70	115	77	165	32	—	—
Condesa 9	33 x 41 x 13	1,353	80	135	90	193	36	—	—
Condesa Commons	85 x 116 x 16	9,860	—	—	—	1,409	—	—	—
Bellavista Boardroom	47 x 22 x 14	1,034	—	—	—	—	Conf 18	—	—
Jardins Boardroom	44 x 22 x 14	968	—	—	—	—	Conf 18	—	—

*All dimensions are pre-opening dimensions and have been rounded to the closest foot

THIRD LEVEL

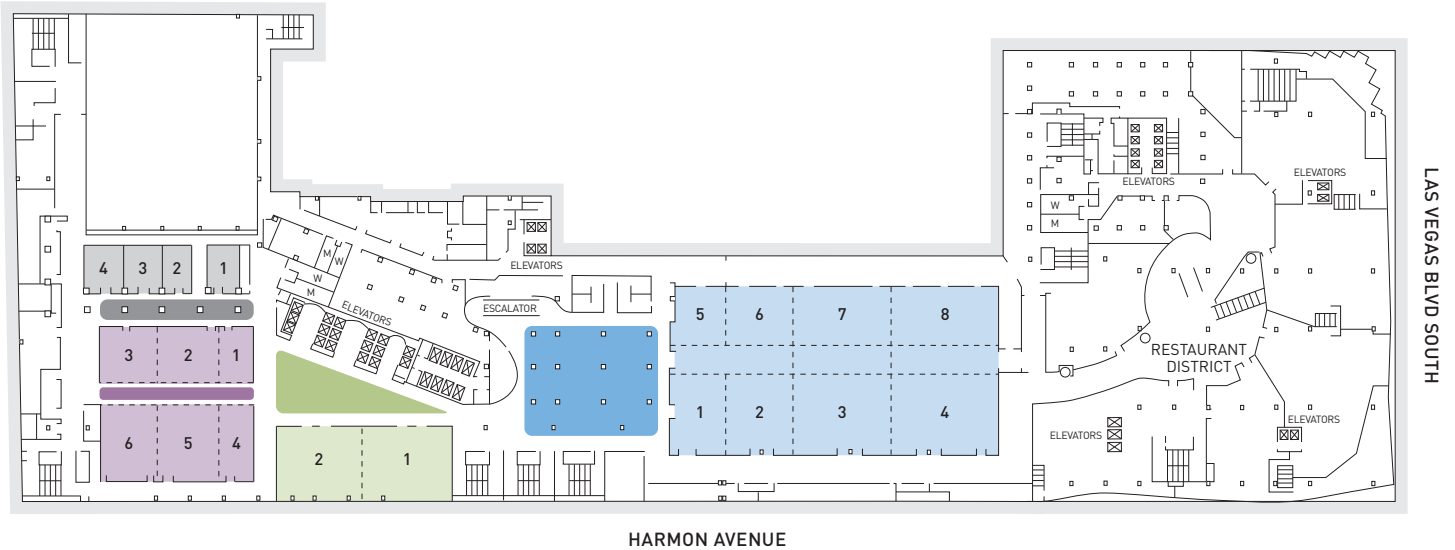

Room Name	Room Dimensions L x W x H	Square Feet*	Banquet 72" Rd.	Theater	Classroom 18"	Reception	Hollow Square	Exhibit 8' x 10'	Exhibit 10' x 10'
Praga 1	31 x 26 x 11	806	50	81	54	115	16	—	—
Praga 2	18 x 26 x 13	468	30	47	31	67	12	—	—
Praga 3	29 x 26 x 13	754	40	75	50	108	16	—	—
Praga 4	31 x 26 x 13	806	50	81	54	115	16	—	—
Praga Commons	121 x 23 x 13	2,783	—	—	186	398	—	—	—
Brera 1	25 x 41 x 14	1,025	60	103	68	146	22	—	—
Brera 2	52 x 41 x 14	2,132	130	213	142	305	52	12	10
Brera 3	45 x 41 x 14	1,845	110	185	123	264	48	11	9
Brera 4	25 x 57 x 14	1,425	80	143	95	204	30	—	—
Brera 5	52 x 57 x 14	2,964	180	296	198	423	—	18	14
Brera 6	45 x 57 x 14	2,565	160	257	171	366	—	16	13
Brera Ballroom (1-6)	120 x 121 x 14	14,520	900	1,452	968	2,074	—	87	70
Brera 1-2	77 x 41 x 14	3,157	190	316	210	451	—	—	—
Brera 1-3	121 x 41 x 14	4,961	310	496	331	709	—	30	24
Brera 2-3	97 x 41 x 14	3,977	240	398	265	568	—	23	19
Brera 5-6	97 x 57 x 14	5,529	340	553	369	790	—	34	27
Brera 4-5	77 x 57 x 14	4,389	270	439	293	627	—	—	—
Brera 4-6	121 x 57 x 14	6,897	430	690	460	985	—	41	33
Brera Commons	22 x 118 x 14	2,596	—	—	173	371	—	—	—
Castellana 1	75 x 58 x 16	4,350	270	435	290	621	—	23	18
Castellana 2	73 x 58 x 16	4,234	260	423	282	605	—	23	18
Castellana Ballroom (1-2)	147 x 58 x 16	8,526	530	853	568	1,218	—	49	31
Castellana Commons	147 x 35 x 14	5,145	—	—	343	735	—	—	—
Gracia 1	28 x 60 x 14	1,680	100	168	112	240	42	10	8
Gracia 2	51 x 60 x 14	3,060	190	306	204	437	—	18	15
Gracia 3	54 x 60 x 14	3,240	200	324	216	463	—	20	16
Gracia 4	84 x 60 x 14	5,040	310	504	336	720	—	30	24
Gracia 5	28 x 46 x 14	1,288	80	129	86	184	32	—	—
Gracia 6	51 x 46 x 14	2,346	140	235	156	335	—	14	11
Gracia 7	54 x 46 x 14	2,484	150	248	166	355	—	15	12
Gracia 8	84 x 46 x 14	3,864	240	386	258	552	—	23	18
Gracia Ballroom (1-8)	217 x 128 x 14	27,776	1,730	2,778	1,852	3,968	—	168	135
Gracia 1-2	79 x 60 x 14	4,740	290	474	316	677	—	28	23
Gracia 1-3	133 x 60 x 14	7,980	490	798	532	1,140	—	47	38
Gracia 1-4	217 x 60 x 14	13,020	860	1,302	868	1,860	—	78	62
Gracia 5-6	79 x 46 x 14	3,634	220	363	242	519	—	21	17
Gracia 5-7	133 x 46 x 14	6,118	380	612	408	874	—	36	27
Gracia 5-8	217 x 46 x 14	9,982	620	998	665	1,426	—	59	47
Gracia 3,7	54 x 128 x 14	6,912	430	691	461	987	—	41	33
Gracia 4,8	84 x 128 x 14	10,752	710	1,075	717	1,536	—	62	50
Gracia 1,2,5,6	79 x 128 x 14	10,112	670	1,011	674	1,445	—	59	47
Gracia Commons	85 x 120 x 14	10,200	—	—	680	—	—	—	—

*All dimensions are pre-opening dimensions and have been rounded to the closest foot

FOURTH LEVEL

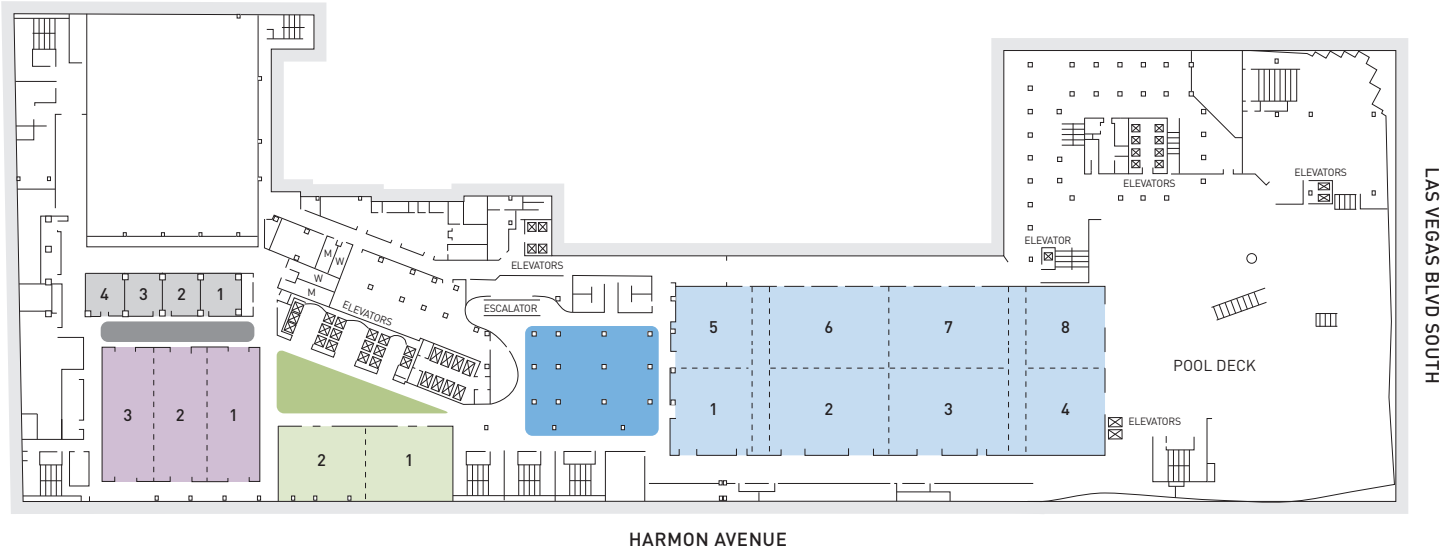

Room Name	Room Dimensions L x W x H	Square Feet*	Banquet 72" Rd.	Theater	Classroom 18"	Reception	Hollow Square	Exhibit 8' x 10'	Exhibit 10' x 10'
Yaletown 1	30 x 41 x 13	1,230	90	123	82	176	30	—	—
Yaletown 2	29 x 41 x 13	1,189	80	119	79	170	24	—	—
Yaletown 3	29 x 41 x 13	1,189	80	119	79	170	24	—	—
Yaletown 4	31 x 41 x 11	1,271	90	127	85	182	30	—	—
Yaletown Commons	121 x 23 x 13	2,783	—	—	—	398	—	—	—
Nolita 1	43 x 80 x 14	3,440	230	344	229	491	—	21	17
Nolita 2	43 x 80 x 14	3,440	230	344	229	491	—	21	17
Nolita 3	43 x 80 x 14	3,440	220	344	229	491	—	21	17
Nolita Ballroom (1-3)	128 x 80 x 14	10,240	640	1,024	683	1,463	—	62	50
Nolita 1-2	86 x 80 x 14	6,880	450	688	459	983	—	41	33
Nolita 2-3	86 x 80 x 14	6,880	450	688	459	983	—	41	33
Mont-Royal 1	74 x 58 x 16	4,292	280	429	286	613	—	23	18
Mont-Royal 2	73 x 58 x 16	4,234	260	423	282	605	—	23	18
Mont-Royal Ballroom (1-2)	147 x 58 x 16	8,526	560	853	568	1,218	—	45	36
Mont-Royal Commons	147 x 35 x 14	5,145	—	—	—	735	—	—	—
Chelsea 1	63 x 61 x 28	3,843	250	384	256	549	—	23	19
Chelsea 2	65 x 63 x 28	4,095	260	410	273	585	—	24	19
Chelsea 3	65 x 63 x 28	4,095	270	410	273	585	—	24	19
Chelsea 4	58 x 63 x 28	3,654	250	365	244	522	—	21	17
Chelsea 5	61 x 61 x 28	3,721	240	372	248	532	—	23	18
Chelsea 6	65 x 61 x 28	3,965	260	397	264	566	—	24	19
Chelsea 7	65 x 61 x 28	3,965	260	397	264	566	—	24	19
Chelsea 8	60 x 61 x 28	3,660	244	366	244	523	—	25	20
Chelsea Ballroom (1-8)	299 x 124 x 28	37,076	2,470	3,708	2,472	5,297	—	231	185
Chelsea 1-2	148 x 63 x 28	9,324	620	932	622	1,332	—	56	45
Chelsea 1-3	213 x 63 x 28	13,419	890	1,342	895	1,917	—	84	67
Chelsea 1-4	299 x 63 x 28	18,837	1,250	1,884	1,256	2,691	—	115	92
Chelsea 2-4	210 x 63 x 28	13,230	880	1,323	882	1,890	—	84	67
Chelsea 5-6	148 x 61 x 28	9,028	600	903	602	1,290	—	56	45
Chelsea 5-7	213 x 61 x 28	12,993	860	1,299	866	1,856	—	78	62
Chelsea 5-8	299 x 61 x 28	18,239	1,210	1,824	1,216	2,606	—	115	92
Chelsea 1,5	61 x 124 x 28	7,564	500	756	504	1,081	—	47	38
Chelsea 2,6	65 x 124 x 28	8,060	530	806	537	1,151	—	50	40
Chelsea 3,7	65 x 124 x 28	8,060	530	806	537	1,151	—	50	40
Chelsea 2,3,6,7	130 x 124 x 28	16,120	1,070	1,612	1,075	2,303	—	100	80
Chelsea 4,8	58 x 124 x 28	7,192	470	719	479	1,027	—	53	42
Chelsea 1,2,5,6	148 x 124 x 28	18,352	1,220	1,835	1,223	2,622	—	112	90
Chelsea 1,2,3,5,6,7	213 x 124 x 28	26,410	1,760	2,641	1,761	3,773	—	162	130
Chelsea 2,3,4,6,7,8	210 x 124 x 28	26,040	1,730	2,604	1,736	3,720	—	168	135
Chelsea Commons	85 x 116 x 16	9,860	—	—	—	1,409	—	—	—

*All dimensions are pre-opening dimensions and have been rounded to the closest foot